

# Maintenance for Innoseal® Sealer

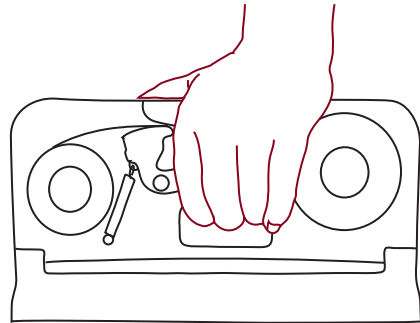

## Step 1: Open the Sealer

Position one hand on top of the Sealer and place fingertips under the lid. Lift up and pull forward. Remove all interior parts from the Sealer.

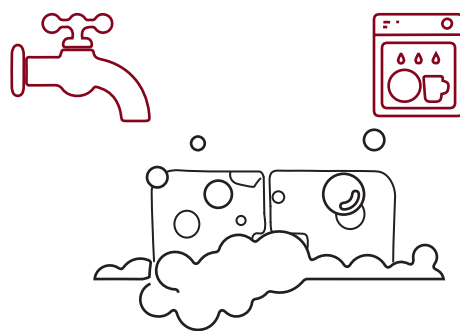

## Step 2: Clean Sealer

Use a damp cloth, soap or the dishwasher to clean your Sealer.

**Caution:** The knife in the knifeholder is extremely sharp!

**Tip:** Clean your Sealer when changing each Refill set, and at least once a year give it a deep cleanse.

- 1) This will extend the lifetime of your Sealer, but most of all it makes sure you can close your bags without problems.
- 2) We recommend to always remove all Sealer parts before cleaning.

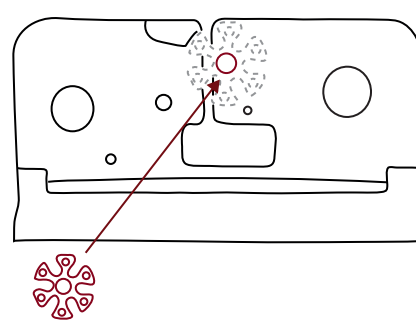

## Step 3: Place Spoke Wheel

Once cleaned, take the Spoke Wheel and place it in the required place; in the center of the Sealer. (See image)

**Tip:** Make sure the flat side faces the inside of the Sealer to ensure the Sealer can later be closed.

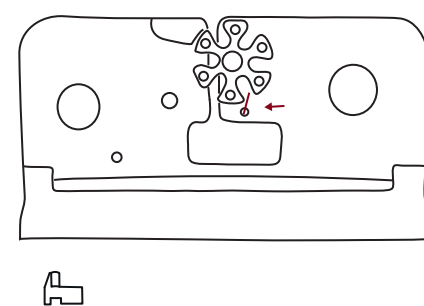

## Step 4: Place Break

The Break needs to be placed in the Breakholder; under the Spoke Wheel (see arrow). The longest side needs to fall into one of the openings of the Spoke Wheel. Push it all the way down towards the inside of the Sealer.

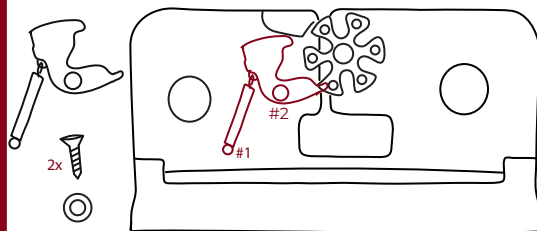

## Step 5: Place Knifeholder

Make sure the spring is attached to the Knifeholder. First place the eye of the spring around spot #1. Guide the Knifeholder to spot #2. The spring is now in tension. To fix the Knifeholder to the inside of your Sealer, place a screw at spot #1 and a screw with a washer at spot #2.

**Caution:** The knife in the Knifeholder is extremely sharp.

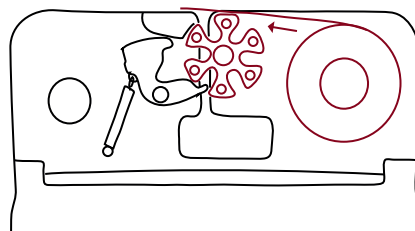

## Step 6: Changing Tape Roll

Load the Tape with the sticky side up. Thread the Tape through the opening, above the Spoke Wheel, and temporarily stick the Tape to the top of the casing.

**Caution:** The Tape can only be loaded one way, so if the lid does not close, the Tape roll must be removed and reversed.

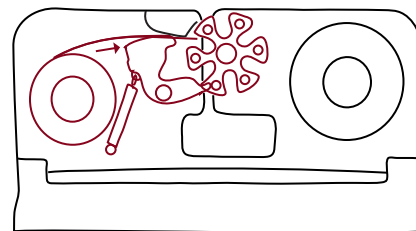

## Step 7: Changing Paper Roll

To load the Paper, assist the end of the Paper roll into one of the Spoke Wheel ports (via the passageway; see arrow). To make sure it fits in the Spoke Wheel port, turn the Spoke Wheel a half-a-click.

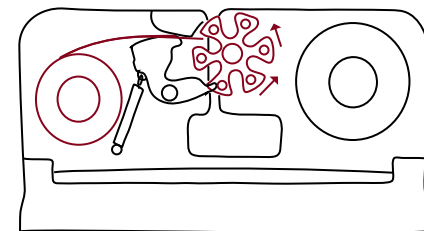

## Step 8: Turn the Spoke Wheel

Before you can use the Sealer turn the Wheel until you hear a full click (counter clockwise). The Wheel now has grip on the paper.

**Seal on!**

**Caution:** The first seal (and sometimes the second) will be lost as the Tape & Paper adjust their alignment, if you do not have a Paper & Tape seal by the third attempt, retrace prior steps.